

UNION SWITCH & SIGNAL COMPANY

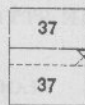

A

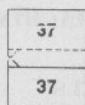
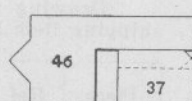
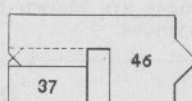
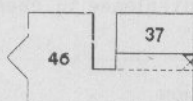
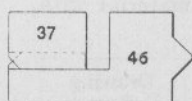

B

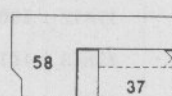
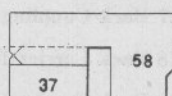
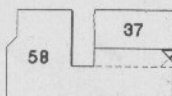
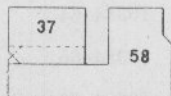

C

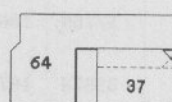
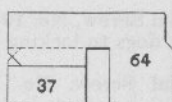
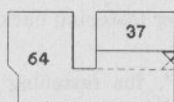
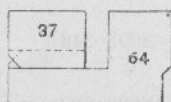

D

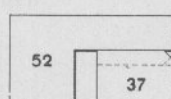
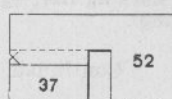
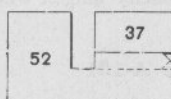
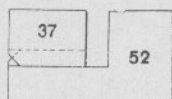

E

ARRANGEMENT OF FRONT LOCKING DOGS FOR STYLE "A"
INTERLOCKING MACHINE

UNION SWITCH & SIGNAL COMPANY

THE STYLE "A" INTERLOCKING MACHINE

ARRANGEMENT OF FRONT LOCKING DOGS

The illustrations on the opposite page show the various possible arrangements of certain front locking dogs when it is desired to economize space in the locking plate.

In each case one of the dogs will engage the special swing dog (No. 76, Plate A-17) when the lever is normal, the other when the lever is reversed.

"A" shows the arrangement of two dogs, Ref. 37, Plate A-129.

"B" shows the arrangement of two dogs, one Ref. 37 and one Ref. 46, Plate A-129.

"C" shows the arrangement of two dogs, one Ref. 37, Plate A-129, and one Ref. 58, Plate A-130.

"D" shows the arrangement of two dogs, one Ref. 37, Plate A-129, and one Ref. 64, Plate A-130.

"E" shows the arrangement of two dogs, one Ref. 37 and one Ref. 52, Plate A-129.